

## INSTRUCTIONS

**MOTOR CADDY™ Outboard Hoisting Harness** is the safe and easy way to move an outboard motor. Provides a balanced, secure handle for easier carrying, hoisting or moving of heavy, cumbersome motors.

Fits 2-stroke and 4-stroke outboards up to 15 h.p. Motor Caddy is sized to quickly attach onto most outboards from 2–15 horsepower. (Not recommended for air cooled motors).

Design features a long harness strap to fit 4-stroke motors and a shorter security strap for extra safety when used on today's streamlined engine cases. Self-centering handle serves as the lifting point for lanyards and hoists or balanced lifting by hand.

Made of UV resistant materials that will endure the marine environment. Tough enough to be left installed on a semi-permanent basis. Glass filled nylon buckles insure that Motor Caddy is easy to install and remove, allowing quick access to the motor.

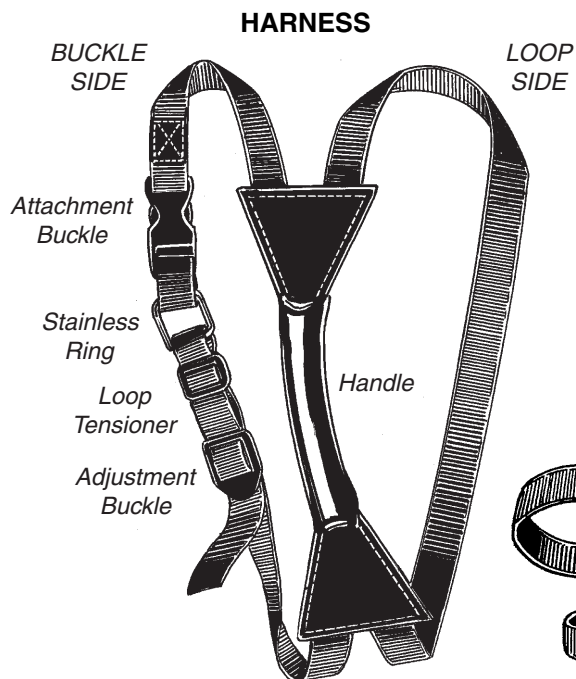

### SECURITY STRAP

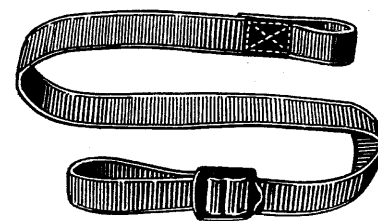

Note: On smaller motors, it may be necessary to trim excess webbing.

## HARNESS INSTALLATION

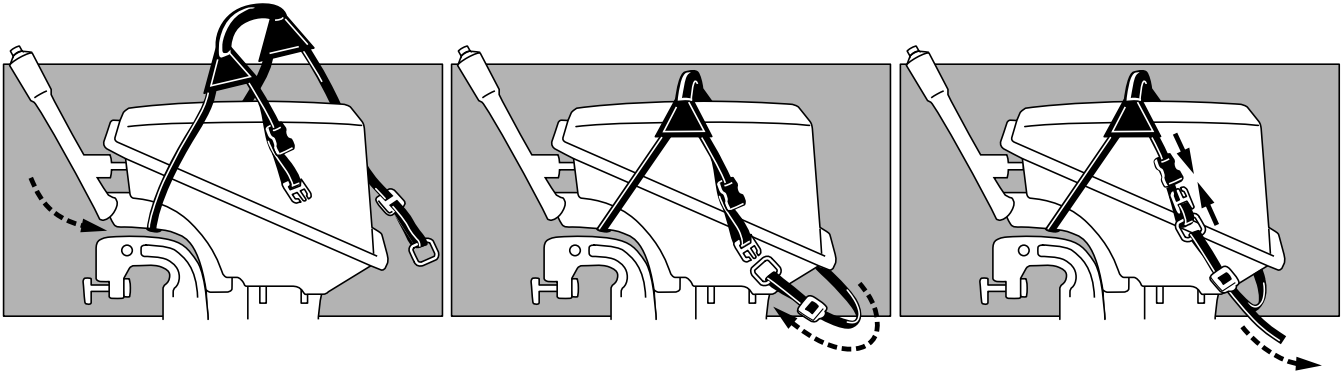

The harness may be installed with buckle on either side of motor. The webbing is one continuous piece; pulling on one side will tension the other side.

With attachment buckle free (open), place the loop side over the motor and position underneath. Make sure there are no twists. Pull on the stainless ring until the loop side becomes taut.

Feed the webbing with the stainless ring underneath the motor until it meets the attachment buckle.

Make sure there are no twists. Placing the adjustment buckle approximately 1 1/2" (38mm) from the end of the webbing will keep extra webbing from flopping about, providing a clean installation.

Slide the attachment buckle through the stainless ring (buckle must be at an angle to slip through the stainless ring). Connect buckle together.

The tension of the webbing may now be changed using the adjustment buckle. The optimum tension is a snug fit all around while still allowing the handle to be grasped. Webbing may have to be slid through handle to achieve a centered fit.

## SECURITY STRAP INSTALLATION

The security strap is included for use on today's streamlined motor cases.

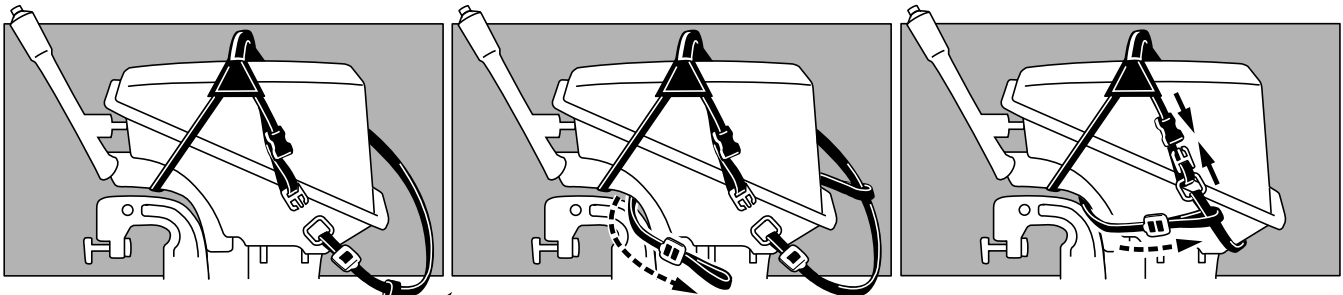

Release the attachment buckle. Slide the security strap's small loop onto the harness webbing in back of motor.

Lead the security strap around the FRONT of the motor.

Slide the security strap's large loop onto the main harness. Close harness attachment buckle (as in third step, above). Tighten harness and security strap webbing.

## **Davis Instruments**

3465 Diablo Ave., Hayward, CA 94545 U.S.A.  
Phone (510) 732-9229 • Fax (510) 732-9188  
info@davisnet.com www.davisnet.com